

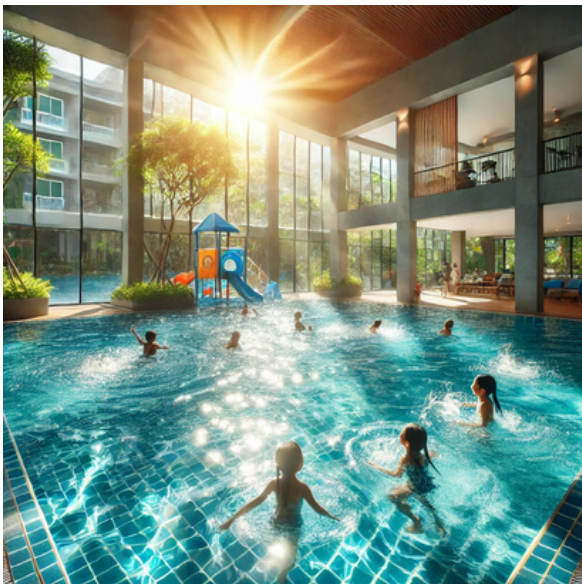

# Potent Bleaching and Efficient Disinfection

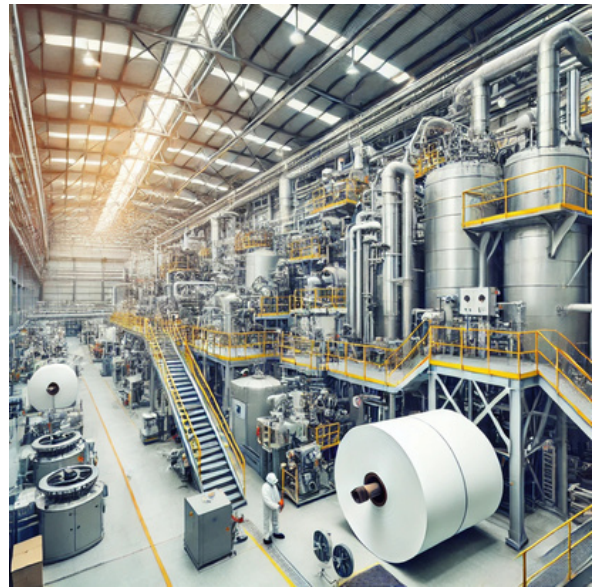

Devoted in Service of Public Health

---



## INTRODUCING CCI BRAND SBP

The Stable Bleaching Powder is being manufactured using indigenous technology developed through rigorous R&D and based on renowned Rheinfelden process under supervision of high qualified scientific & engineering personal.

CCI BRAND Stable Bleaching Powder offers high available chlorine and exceptional stability, making it safe for extended storage. Our ISI-marked products are available in four variants, compliant with **IS 1065 (Part-2): 2019** for drinking water treatment (**Type-1 and Type-2**) and **IS 1065 (Part-1): 2019** for household and industrial applications (**Grade-1 and Grade-2**).



## ABOUT US

CHLOROCHEM INDUSTRIES (CCI), a pioneer in Stable Bleaching Powder manufacturing at Kota, Rajasthan. Started in 1975, we have been consistently devoted in service of Public Health by supplying our best quality products widely used for drinking water purification to Various Government and Private Agencies in India as well as globally.

## SALIENT FEATURES

- 01** The stability of CCI BRAND SBP surpasses that of other brands due to premium raw materials, rigorous quality control, and advanced process management.
  - 02** CCI BRAND SBP releases 90-95% of its chlorine within 15 minutes, ensuring fast and effective bleaching and thorough disinfection.
  - 03** When used in water for disinfection or sterilization, CCI BRAND SBP leaves minimal residue due to its high reactivity.
-

# APPLICATIONS



In Textile Industry, as a bleaching agent

Sanitizer during Epidemic Control



In Carpet Industry for extra shine

Disinfectant in treatment of potable water



Pulp and paper industry for bleaching

Hospitals, Hotels, Offices for disinfecting



Swimming Pools Disinfection

Sewage Disposal for disinfection and deodourisation

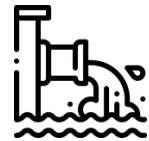

Sodium Silicate Industry for curing and extra shine

Laundry for bleaching



Leather Industry

Use as Chemical Reagent



## CERTIFICATIONS

We manufacture all Types and Grades of Stable Bleaching Powder (SBP) of high quality and have BIS (Bureau of India Standards) certifications for both the BIS Standards namely IS 1065 (Part-2) 2019 for Treatment of Water Intended for Drinking and IS 1065 (Part-1) 2019 for Household and Industrial Use.

Our offerings include: -

- SBP as per - IS 1065 (Part-2) Type-1
- SBP as per - IS 1065 (Part-2) Type-2
- SBP as per - IS 1065 (Part-1) Grade-1
- SBP as per - IS 1065 (Part-1) Grade-2



# WHY US?

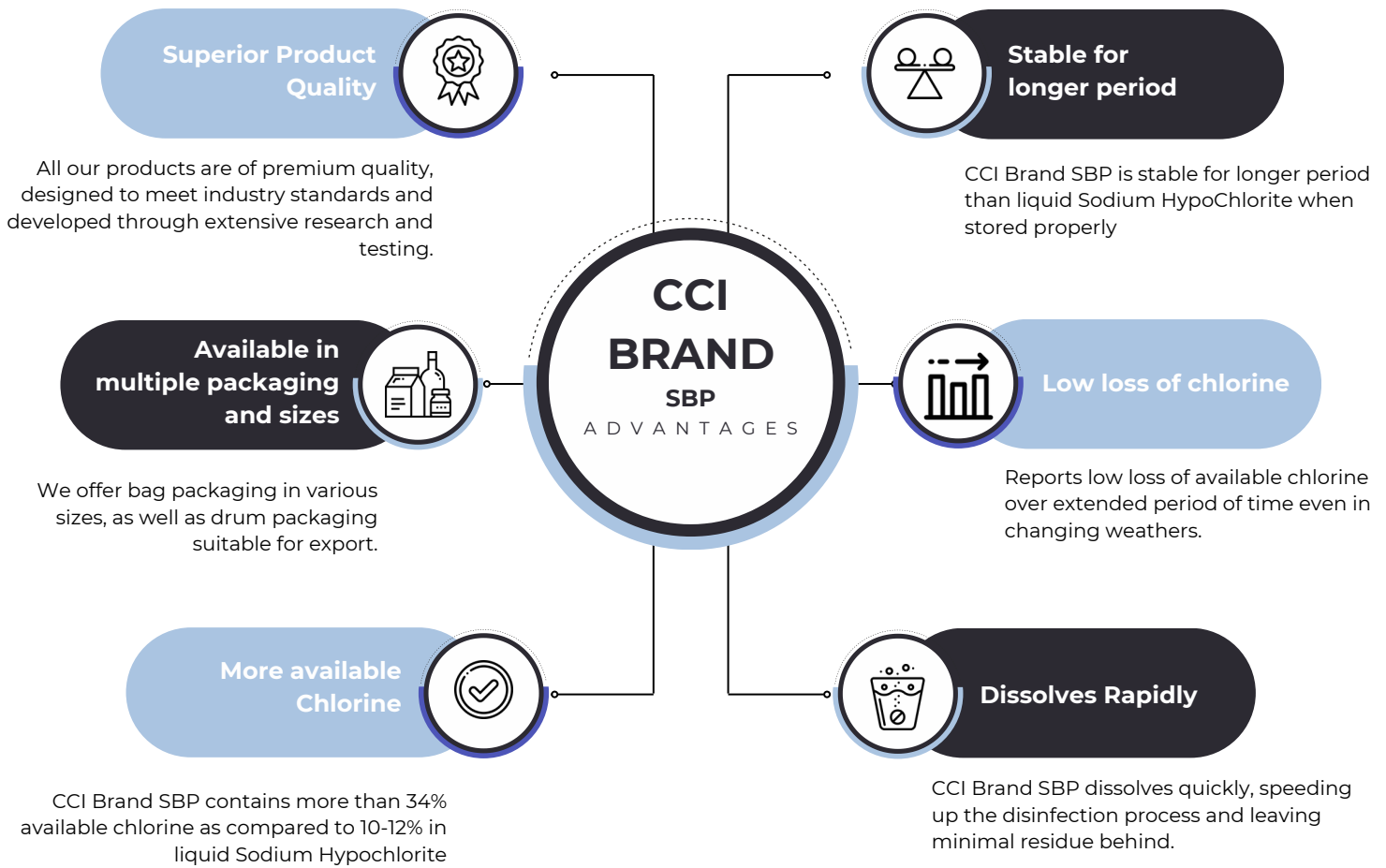

# PRODUCT PARAMETERS

We offer four product types, with general specifications provided below.

## Household and Industrial Use

PARAMETERS	SPECIFICATIONS IS 1065 (Part1) Grade1	SPECIFICATIONS IS 1065 (Part1) Grade2
General Appearance	Dry free flowing white powder free from hard lumps and other visible impurities	Dry free flowing white powder free from hard lumps and other visible impurities
Available Chlorine	34.0	32.0
Stability	1/15	1/11
Moisture	0.3	0.5
Particle Size	99.5	99.0



Treatment of water intended for drinking

PARAMETERS	SPECIFICATIONS IS 1065 (Part2) Type1	SPECIFICATIONS IS 1065 (Part2) Type2
General Appearance	Dry free flowing white powder free from hard lumps and other visible impurities	Dry free flowing white powder free from hard lumps and other visible impurities
Available Chlorine	34.0	32.0
Stability	1/15	1/11
Moisture	0.3	0.5
Particle Size	99.5	99.0
Lead (as Pb) ppm, Max	70	70
Arsenic (as As) ppm, Max	10	10
Manganese (as Mn) ppm, Max	250	250
Chromium	20	20
Mercury (as Hg) ppm, Max	5	5
Cadmium (as Cd) ppm, Max	10	10
Selenium (as Se) ppm, Max	10	10

## PACKAGING

- 25 Kg Laminated HDPE bags with double LDPE liner inside
- 50 kg Galvanized Iron drums, designed to resist rust and chlorine, with an additional LDPE inner liner
- 25/45/50 kg HDPE drums with extra LDPE inner liners
- 50/100lb metallic drums with additional LDPE inner liners



## GUIDELINES

- CCI Brand SBP is easy to handle, store and convenient to dose.
- Avoid using hooks during handling, loading, unloading or stacking.
- Store Stable Bleaching Powder (SBP) in a dark, cool and well-covered location to prevent chlorine loss.
- Do not store SBP in areas with smoke, acid vapours, water vapours or other harmful substances to maintain quality.
- Keep the product away from direct sunlight.
- After use, ensure the container lid is closed or the bag is tightly tied to prevent contamination.
- Consume the material promptly after opening the container or bag.

## MEASURES

- Avoid contact with eyes. Do not swallow or drop the material.
- Handle with care; avoid impacts as they can cause ignition.
- Do not store at high temperatures to prevent the release of oxygen and reduce the risk of fire.
- Keep away from rubber, cloth, paper, wood chips and other flammable materials to avoid fire hazards.
- Prevent contact with acids, as this will release chlorine.
- Use plastic, glass or clay tools (e.g. vessels, shovels, stirring rods) when handling the powder to avoid corrosion, especially in the presence of moisture.

Contact Us



+91-9829037067  
+91-9829035067



chlorochem@gmail.com



www.chlorochem.com



Chlorochem Industries,  
E-57 Indraprastha  
Industrial Area, Kota -  
324005 Rajasthan (India)